

TEST PRESSURE BAR / PSI		
API 6D	SHELL	SEAT
HYDROSTATIC	75 / 1087	55 / 798

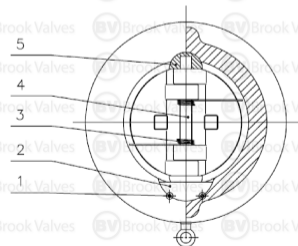
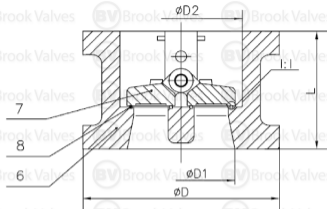

NO.	PART NAME	MATERIAL
1	SCREW	A193 B7
2	WASHER	A276 316
3	SPRING	INCONEL X-750
4	HINGE PIN	A276 316
5	PIN SEAT	A276 316
6	BODY	A216 WCB
7	DISC	A351 CF8M
8	SEAT	VITON

SIZE	SIZE: MM				
	L	D	D1	D2	
50	60	110	50	60	
65	67	128	65	65	
80	73	147	80	88	
100	73	179	100	104	
125	86	214	125	129	
150	98	249	150	160	
200	127	305	203	210	
250	146	359	254	266	
300	181	420	300	290	
350	222	483	350	340	
400	232	537	400	390	
450	264	594	450	440	
500	292	652	500	490	
600	318	772	600	580	

DESIGN & MFT	API 594	END CONNECTIONS	WAFER
PRE-TEMP RATING	ASME B16.34	INSPECT & TEST	API 598
F-F DIMENSION	API 594	FLANGED DIMENSION	ASME B16.5
MARKING	MSS-SP-25	FIRE SAFE DESIGN	NA
PAINTING	STD SILVER	LOGO	BV IN A CIRCLE

TO NACE MR-01-75 ON REQUEST

REV	B	BROOK VALVES CS300 DUO VITON
DATE	Jun-20	
SCALE	TO FIT	

300 LB WCB DUAL PLATE WAFER TYPE CHECK VALVE (RETAINERLESS)